

DETAIL A

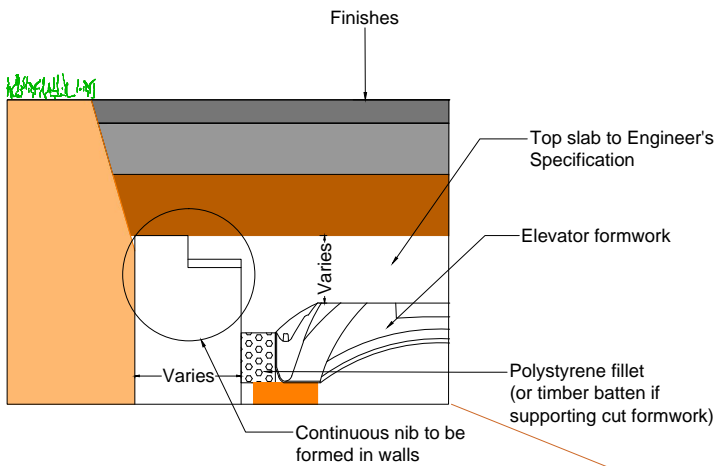

Notes:

- Reinforcement not shown for clarity
- All design work is to be undertaken by a suitably qualified civil or structural engineer

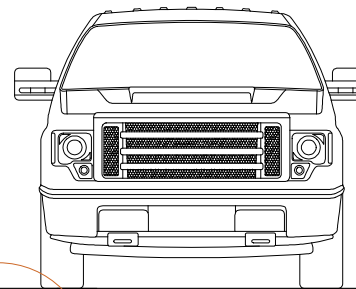

DETAIL A

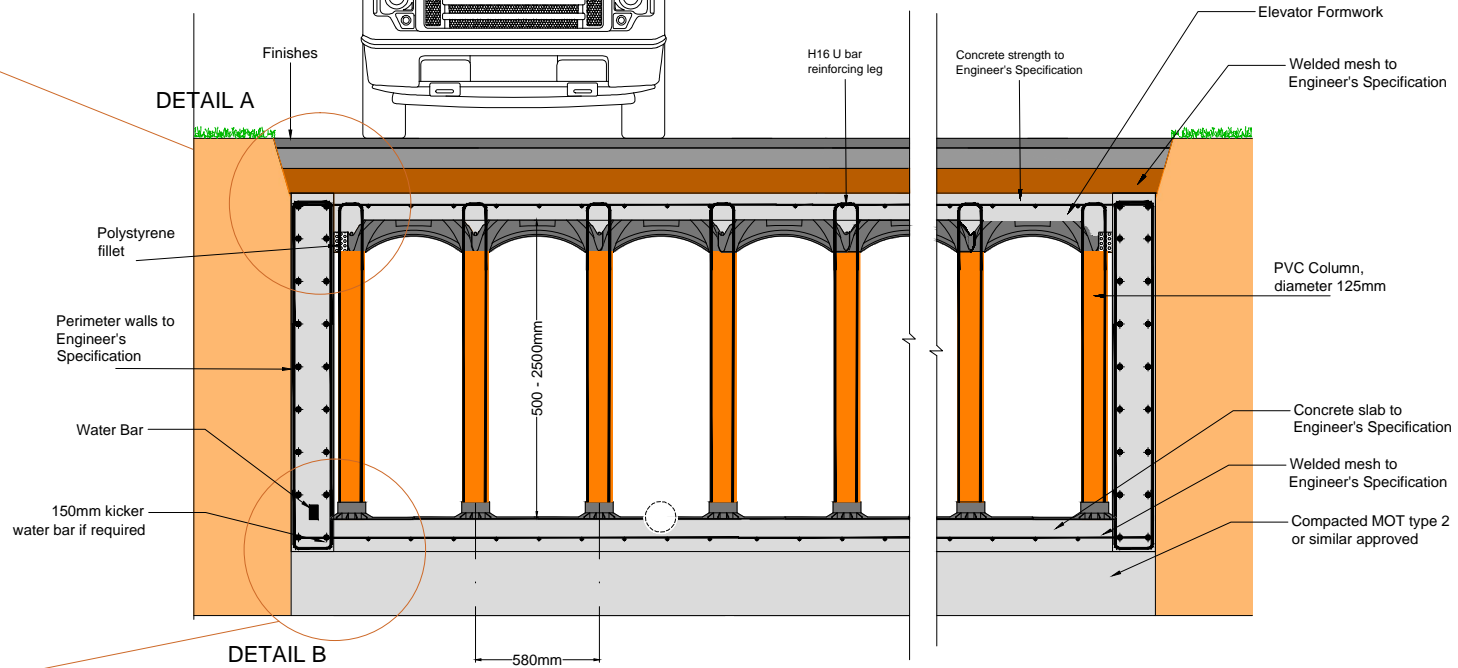

DETAIL B

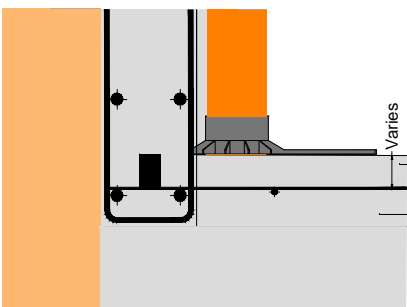

Notes: Continuity Steel to be provided between slab and walls to Engineer's Specification

Notes:

- Reinforcement not shown for clarity
- All design work is to be undertaken by a suitably qualified civil or structural engineer

Stormwater Management

Fleming Road, Harrowbrook Industrial Estate,
Hinckley, Leicestershire. LE10 3DU
Tel: 01455 502222 Fax: 01455 502223 www.storm-water.co.uk

TITLE:

Elevator typical cross section Low Flow

DRAWN BY:

ZS

SCALE:

NTS

DATE:

21/12/16

CHECKED BY:

NRW

REF:

STW-EVL-02

VERSION:

V1

SHEET: